

## Adhesive Application to Bridge Gap Between Pans

Line up the drilled holes on the end wall of the beginning pan to the drilled holes on one end wall of the second pan. Pull back the second pan enough to be able to apply the adhesive to the outside of the end walls that will be attached together.

Using the adhesive dispenser, apply adhesive to each side of the end wall of each pan. If a drain is installed, adhesive should also be applied to the drain.

For center pans, use a “figure eight” pattern to apply a thick bead of adhesive on both the first and second pan.

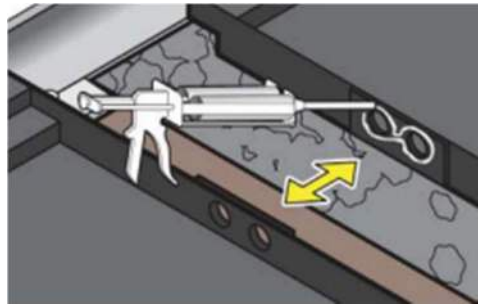

For side pans, make complete circles around the drilled hole on both the first and second pan:

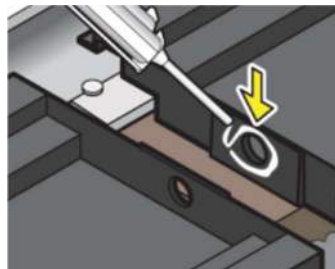

Push the second pan into the first pan, while keeping the first pan in place, carefully aligning the flowthrough holes in each end wall. If a drain is installed, the hole in the track pan should be lined up with the drain at the same time aligning the holes in the end walls. Once the two pans are together, use C-clamps to tighten the two pans together between the two flow through holes and on the outside of each flow through hole. C-clamps should also be used for the drain area if one is installed.

While wearing chemical resistant gloves, wipe the excess off of the inside of each flow through hole and any excess that has come up over the end walls.

**IT IS IMPORTANT TO NOTE THE PAN ENDS WILL NOT FULLY CONNECT, THE THICK BEADS OF ADHESIVE ON BOTH SIDES OF THE PANS WILL BRIDGE THE SMALL GAP BETWEEN THE PANS.**