

Grate-Inlet Measurement Form

Send completed form(s) to customerservice@ultratechbrands.com

Distributor/Contractor: _____ Contact: _____ Ph#: _____

Email: _____ Project Name: _____ Town/City: _____

Catch Basin Location/St: _____ Cross St: _____ Basin ID#: _____ ID# on Grate: Y/N

Section 1

This form is designed to collect the critical as-built inlet information that will facilitate the manufacturing of a WQI that will fit the inlet properly. Specifically, the dimensions of the grate (including ribs, if any), grate frame, clear space within the inlet and any protrusions into that clear space, as well as the inlet depth.



Section 2

- Round Inlet:**
Use Frame width (1)
- Sq. or Rec. Inlet:**
Use Frame Length (1) & Width (2)
- Combination Inlet:**
Use Frame Length (1) & Width (2)

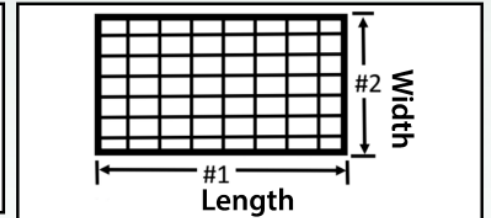
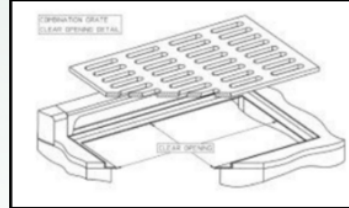
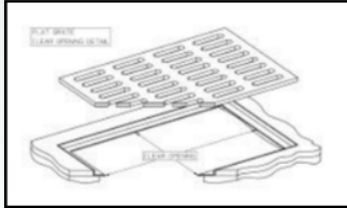
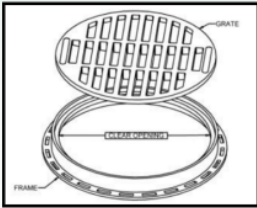

Flat Bottom Grate Type A:

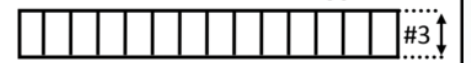

Tapered/Ribbed Grate Type B:

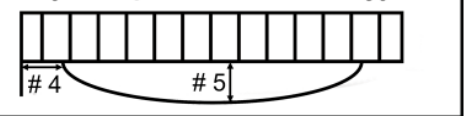

Grate Information (in Inches) —See Guidance at Right

Grate Width #1	Grate Length #2	Grate Style A or B below	Grate Thickness #3	Distance to Taper #4	Thickness of Grate Rib #5
				L:	
				W:	

Section 3

Catch Basin Measurements (In Inches)

A: Grate Frame Opening — Width (A on diagram) @ Top of Grate Frame	
B: Grate Frame Opening — Length (B on diagram) @ Top of Grate Frame	
C: Clear Space Opening — Width (C on diagram) @ Bottom of Grate Frame	
D: Clear Space Opening — Length (D on diagram) @ Bottom of Grate Frame	
E: Depth of CB: From C (on diagram) to Bottom of Inlet, if > 30" Check Box <input type="checkbox"/>, if < 30" =	

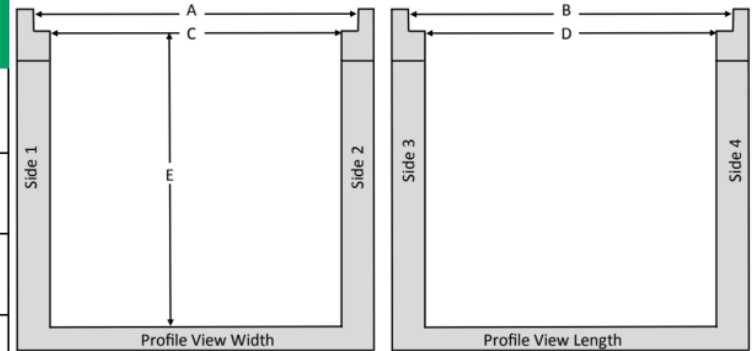

Use the profile views upper right and plan views lower right to illustrate protrusions. Combination inlets use "Side 1" as curb side. Use circle for round inlets.

Section 4

Protrusions: Draw Protrusion(s) in Profile and Plan Views at Right and list below. All dimensions in inches: Depth (from C), Width (how far out from the wall), Length (how far along the wall does protrusion run).

Side =	D =	W =	L =
Side =	D =	W =	L =
Side =	D =	W =	L =
Side =	D =	W =	L =

